

[1] Example glazing unit: HS-laminated triple glazed unit  
 - 6mm HST toughened soft coat low-E outer pane  
 - 14mm argon-filled cavity, black warm edge spacer  
 - 6mm HST toughened soft coat low-E mid pane  
 - 14mm argon-filled cavity, black warm edge spacer  
 - 11.5mm HS-laminated inner pane

[2] Example of roofing:  
 - Plain slates at 100mm gauge with double overlap  
 - 36 x 18mm battens  
 - 4 x 2in rafters and trimmers

[3] Flashing kit:  
 - If specified then supplied by GV  
 - Otherwise supplied by others  
 - All lead to be code 4 (apx. 1.8mm)  
 - All aprons to be of underlay at least 1m wide  
 - Consider clipping flashings and soakers down in severe exposures

[4] Mortar beds are NOT suitable for use with this product  
 - In case of damage to the glass, the entire unit is expected to be replaced

[5] Example of internal finish:  
 - Plasterboard spaced away from the rafters/structural trimmers using 2in timber  
 - Space between plasterboard and aluminium frame of Pitchglaze insulated

[6] Fixings:  
 - Woodscrews and a selection of plastic packers supplied by GV

Please Note  
 These products can be very heavy. GV strongly recommend that a structural engineer is consulted when designing the structure(s) that will support the Pitchglaze and the surrounding roof. The roofing materials & construction shown in these details are presented as an example only. This drawing does not constitute a structural proposal.

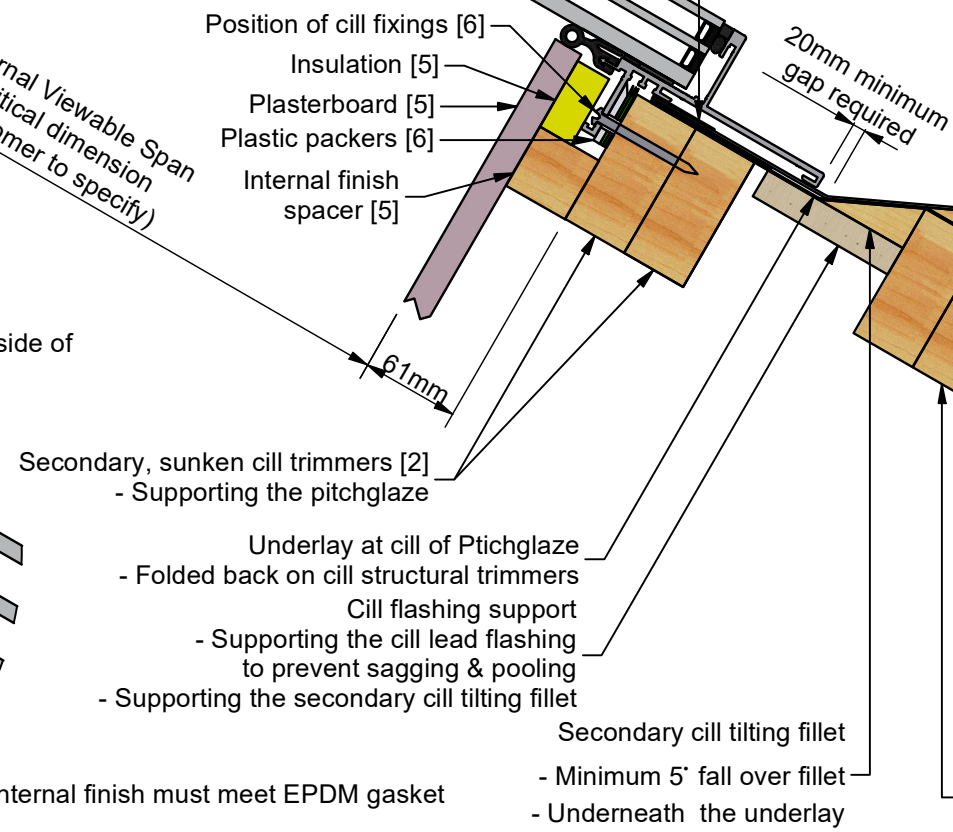
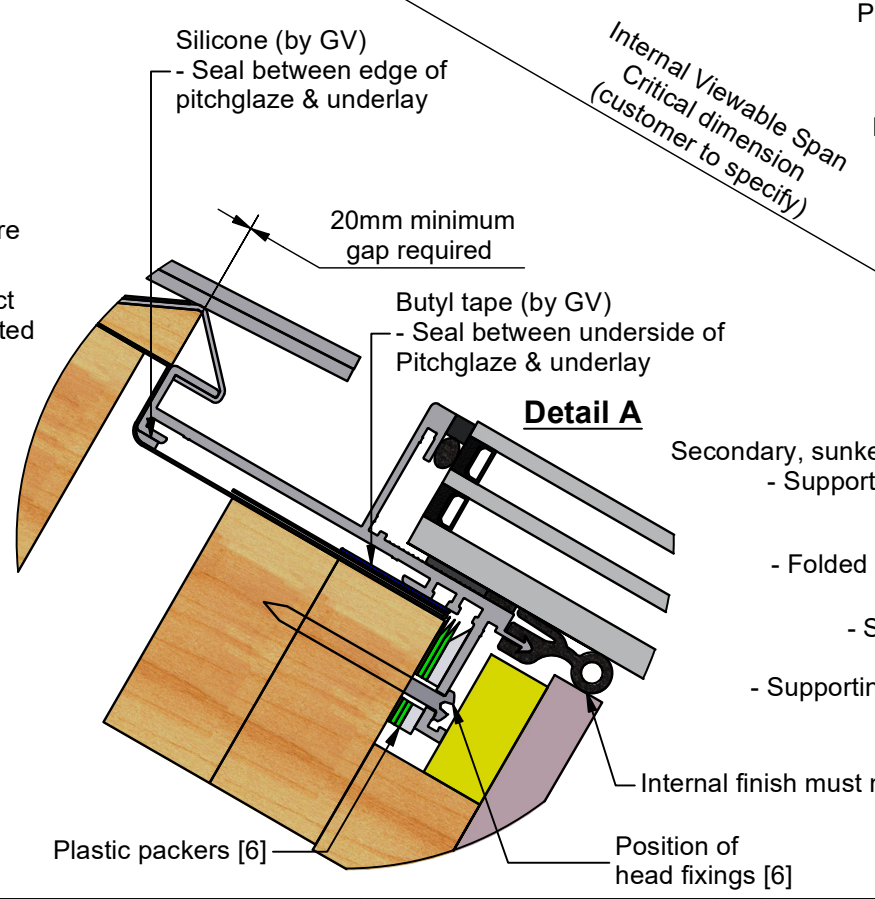

Rev	Revision Description	Drawn/Date
B	Added 20mm minimum gap required between Rooflight and jamb structural rafters	HTT 16/04/2024
A	Difference between secondary, sunken rafter/trimmer opening and internal viewable opening revised from 65mm	JSL 08/11/2018

<b>Product:</b> 201 - GV Standard Pitchglaze MkII	<b>Checked By:</b> ASB
<b>Description:</b> Sunken Installation	<b>Check Date:</b> 16/04/2024
<b>Materials:</b> AS SITE HARDWARE LIST	<b>Drawn By:</b> JSL
<b>Finish:</b> -	<b>Drawn Date:</b> 12/04/2018
<b>Weight:</b> N/A	<b>Quantity:</b> -
<b>Scale:</b> NTS	<b>Drawing No:</b> 201-ASS-103